

Always check the website for the most updated specifications: [www.americh.com](http://www.americh.com)

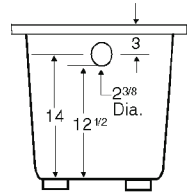

Tub pictured with optional grab bars and waste & overflow.

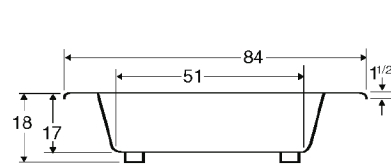
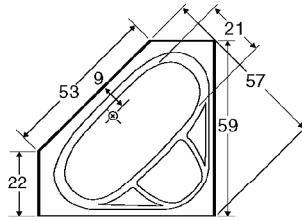

All bathtub dimensions are  $\pm 1/2''$ .

**CODES AND COMPLIANCE**

Americh products meet or exceed the following standards:

- Underwriters Laboratories (UL)
- Underwriters Laboratories - Canada (cUL)
- Canadian Standards Association - (CSA)
- ANSI Z124.1 • ANSI A112-19.7
- ANSI A112.19.8 • ASTM F462-79

Contact Americh for additional approvals.

**MATERIAL**

Acrylic

**DIMENSIONS**

59" x 59" x 18" deep (1499 x 1499 x 457 mm)

Whirlpool Operating Gallons = 50 (Liters = 189)

Gallon to Overflow = 65 (Liters = 246)

**ELECTRICAL REQUIREMENTS**

Americh recommends one 20 amp ground fault circuit interrupter (GFCI) for each power supply provided with the bathtub.

**Builder Series**

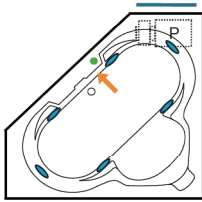

**Luxury Series**

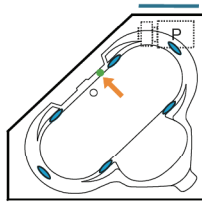

**Platinum Series**

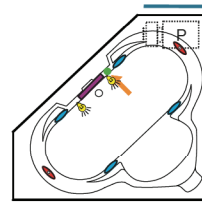

**Combination**

(pump and blower location only)

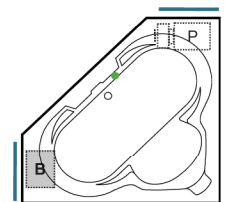

**Airbath System II**

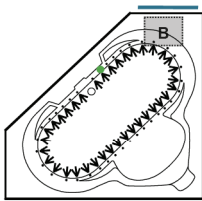

**Airbath System III**

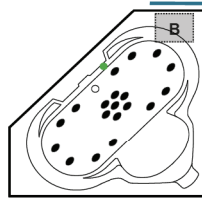

**LEGEND:**

- P PUMP
- B BLOWER
- JET
- ROTARY JET
- DUAL SUCTION
- LIGHT
- ON/OFF CONTROL
- GRAB BAR
- ACCESS PANEL (MINIMUM 16" X 20")

**ACCESSORIES**

Apron	Grab Bars					Pillow					Tile Flange	Installation	
	9"	14"	16"	Madison	Rail	13"	17"	Angle	Head Support System	Deckmount		Undermount	
•	•	•	•		•	•			•	•	Yes	No	

• = option is available    
   = standard on Platinum Series    
   = option is not available

**INSTALLATION TIPS**

- Install product according to Owners Manual and local codes.
- All units with an Airbath III may be 1 1/2 - 2 1/2" higher than stated.
- Any whirlpool or Airbath® unit requires an access panel.
- Hot water supply should be 65-75% of tub capacity or greater. Always consult your local plumber for recommendations as installations will vary.
- For oval or specialty shapes, Americh recommends you wait until you have the actual unit or contact us for a template.